

Exits & Exit Routes



Safety Task - 99To2a2

Compliance Standard

All exits properly marked and illuminated with a reliable light source. Exits doors shall not be locked except under approved exceptions (panic bars, latch or seal which releases under 15 lbs. of force or less, automatic system which unlocks doors under emergency conditions). Any door that is not an exit will be identified as such.

Safety Task - 99To2a2

Exits & Exit Routes

Task Description

Verify that all exits are marked with an exit sign and properly illuminated. Verify that all doors are unlocked (or meet the exceptions) and that exits are free from obstruction. All doors that are not exits are marked with the name of room or "Not an Exit".

Exits & Exit Routes

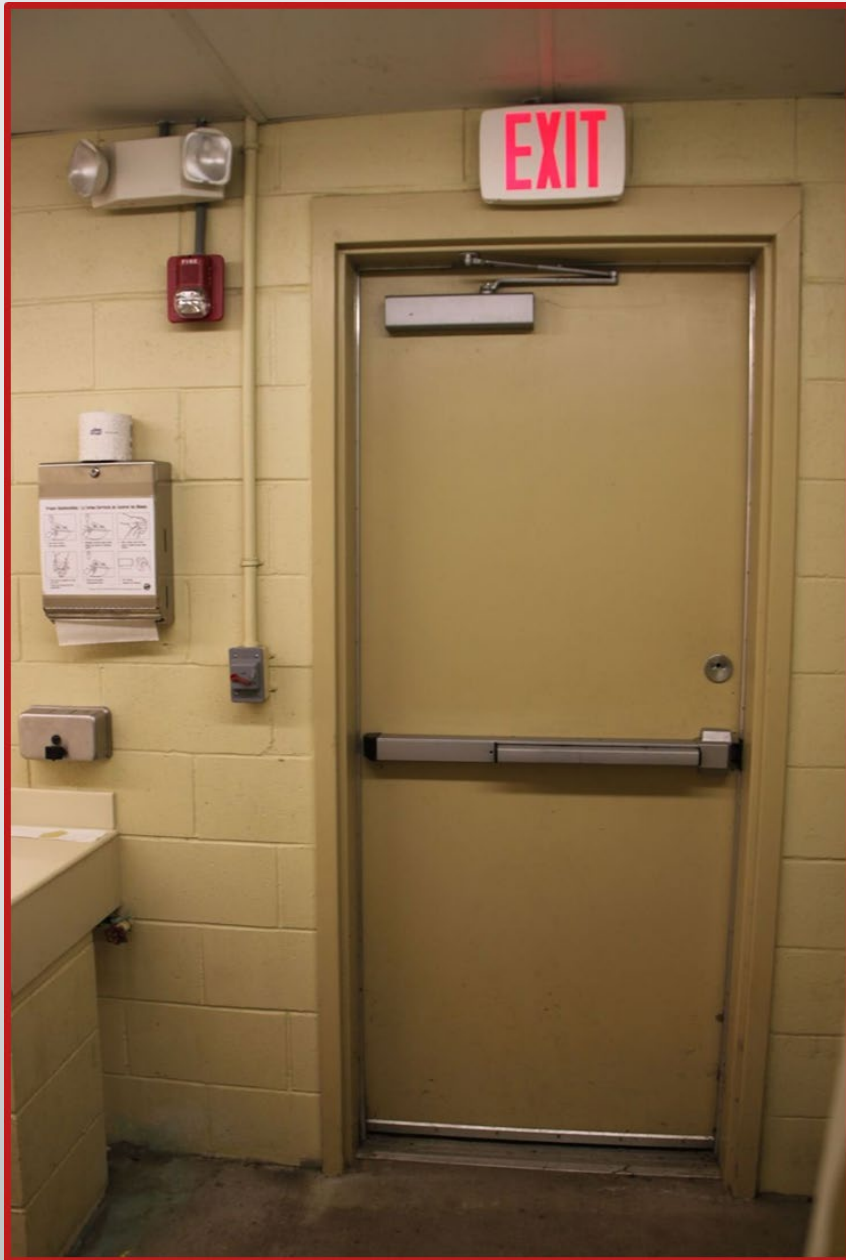

1910.37(b)(2)

Each exit must be clearly visible and mark by a sign reading "Exit."

Examples of Exit Signs

Exits & Exit Routes



Exits & Exit Routes



1910.37(b)(1)

Each exit route must be adequately lighted so that an employee with normal vision can see along the exit route.

Exits & Exit Routes



1910.36(d)(1)

Employees must be able to open an exit route door from the inside at all times without keys, tools, or special knowledge. A device such as a panic bar that locks only from the outside is permitted on exit discharge doors.

Exits & Exit Routes



This door as shown does not meet the requirements of 1910.36(d)(1) because the door is locked.

Exits & Exit Routes



The deadbolt is locked, therefore the door does not meet the requirements of 1910.36(d)(1).

Exits & Exit Routes



The chain with padlock on the door does not meet the requirements of 1910.36(d)(1) if the build is occupied.

Exits & Exit Routes

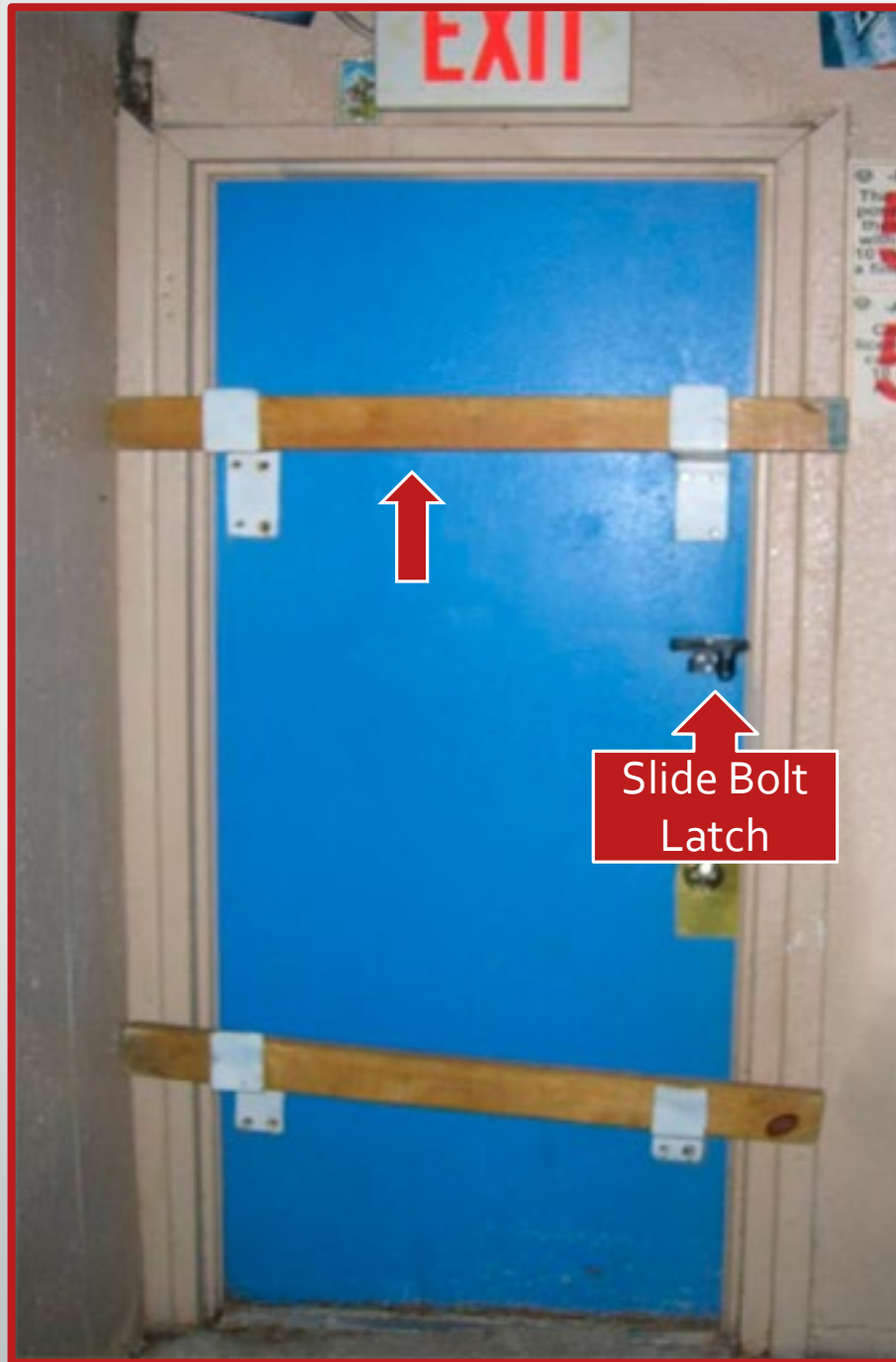

Wood or bars across an exit door while the building is occupied does not meet the requirements of 1910.36(d)(1). Nor does the closed slide bolt latch.

Exits & Exit Routes



1910.37(a)(3)

Exit routes must be free and unobstructed. No materials or equipment may be placed, either permanently or temporarily, within the exit route. The exit access must not go through a room that can be locked, such as a bathroom, to reach an exit or exit discharge, nor may it lead to a dead-end corridor. Stairs or a ramp must be provided where the exit route is not substantially level.

Exits & Exit Routes



The hand cart with supplies is obstructing (blocking) the path to the exit. Therefore, the requirements of 1910.37(a)(3) are not being met.

Exits & Exit Routes



The exit door is obstructed by the pallet and pallet jack. This does not meet the requirements of 1910.37(a)(3)

Exits & Exit Routes



Multiple pallets of product are obstructing the exit and exit route. The yellow lines on the floor identify the exit route that must be clear.

Exits & Exit Routes



The exit door is obstructed by the forklift. This does not meet the requirements of 1910.37(a)(3)

Exits & Exit Routes



The exit door is obstructed by empty boxes. This does not meet the requirements of 1910.37(a)(3) even though the boxes will only be there temporarily.

Exits & Exit Routes



Where do I begin!
This does not
meet the
requirements of
1910.37(a)(3)

Exits & Exit Routes



The exit door on the outside is obstructed by snow. This does not meet the requirements of 1910.37(a)(3)

Exits & Exit Routes



The exit doorway is obstructed by a wall. Some establishment will seal off exits when adding additions on. This does not meet the requirements of 1910.37(a)(3)

Exits & Exit Routes



1910.37(b)(5)

Each doorway or passage along an exit access that could be mistaken for an exit must be marked "Not an Exit" or similar designation, or be a sign indicating its actual use (*e.g.*, closet).

Exits & Exit Routes

